

OWNER'S MANUAL

AYTECH AIS 12 INERTIA SHOTGUN

TACTICAL



AYTAC AR-GE IND. & TRADE LTD.

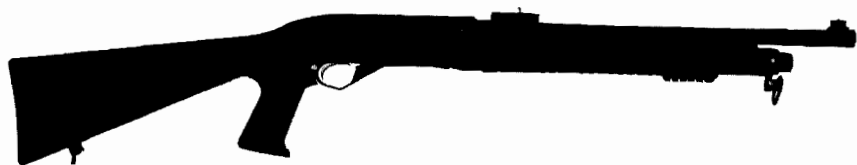

CONTENTS

Firearms Safety	Page 2-3
Introduction - Operation	Page 4
Assembly	Page 5-7
Manual Safety	Page 7
Loading - Firing	Page 8-10
Unloading	Page 11
Disassembly	Page 11-13
Disassembly of the Bolt	Page 14
Disassembly of the Stock	Page 15-16
Disassembly of the Trigger	Page 17
Assembly of the Stock	Page 18
Disassembly of the Magazine Tube	Page 18-21
Maintenance	Page 22
Ammunition	Page 23
Choke Tube Operation	Page 23-24
Technical Drawings and Parts Lists	Page 25-31
Shotgun Features	Page 32
Warranty - Warranty Card	Page 33-34

FIREARMS SAFETY



WARNING: This manual contains operating, care and maintenance instructions. To ensure safe operation, any user of this firearm must read and understand this manual before using the firearm. Disregarding instructions in this manual can cause property damage, personal injury or death to you or those around you. This manual should always accompany this firearm, and be transferred with it upon change of ownership.

1. Never point a firearm at something that's not safe to shoot. Always be certain of your target before firing. Never let the muzzle of a firearm point at any part of your body or at another person.
2. Always handle and treat a firearm as if it is loaded. Always check it yourself with your fingers off the trigger and the gun pointed in a safe direction. Never assume that a firearm is unloaded.
3. Always wear shooting glasses and ear protection when shooting. Wear protective shooting glasses to guard against falling shot, clay target chips, powder residue, ruptured cartridge cases and even twigs and branches in the field. Repeated exposure to gunfire can cause hearing damage. Wear ear protection to guard against such damage.
4. Keep the firearm unloaded during transport.
5. Use proper ammunition. Confusing shells or cartridges can cause serious personal injury or death and destroy your firearm. Examine your shells or cartridges closely and use only the precise caliber or gauge for your specific firearm. Only use factory-loaded and new ammunition. Nevertheless, we can assume no liability for incidents which occur through the use of shells of nonstandard dimensions or which develop pressures in excess of commercially available ammunition which has been loaded in accordance with standards established by SAAMI (U.S.A.) or CIP (Europe and elsewhere).

6. Keep all firearms and ammunition out of the reach of children.
7. Never shoot at water, rocks or any hard surface. Shots may glance off such surfaces and cause injuries.
8. Unload your firearm when you have stopped shooting and when you have to climb a tree, fence, cross a slippery surface or have to transport it in a vehicle.
9. Do not use alcohol or drugs before or while handling firearms.
10. Learn to clean your firearm thoroughly and make certain no oil, grease or other materials are blocking the barrel. Obstructions of any kind can cause damage to the firearm and could cause serious injury or death to you or those around you.
11. Never touch the trigger on a firearm until you are ready to shoot. Keep your fingers away from the trigger when you're loading or unloading. Don't pull the trigger when the safety is engaged or positioned between safe and discharge.
12. Never leave a loaded firearm unattended. Store your firearms and ammunition separately.



STATE WARNING: According to state law, California requires that firearm manufacturers, distributors and retailers include conspicuous, specific warnings with firearms sold in that state. Firearms must be handled responsibly and securely stored to prevent access by children and other unauthorized users. California has strict laws pertaining to firearms, and you may be fined or imprisoned if you fail to comply with them. Visit the Web site of the California Attorney General at <https://oag.ca.gov/firearms> for information on firearm laws applicable to you and how you can comply. Prevent child access by always keeping guns locked away and unloaded when not in use.

INTRODUCTION

Aytech represents a new generation 12 ga inertia shotgun with new improvements. Every single detail of the AIS 12 shotgun is engineered to provide you the most reliable operation and handling. The firearm is capable of firing successive shots with 12 ga 2¾" and 3" shotshell cartridges interchangeably. AIS 12 even runs 2¾" 7/8 oz light field loads flawlessly.

OPERATION

Aytech AIS 12 Tactical is an inertia shotgun that uses recoil-operated system. Upon firing, recoil acts upon the slide assembly and compresses the recoil spring. When the energy from the recoil spring is released, the energy causes the slide to travel rearward, unlocking the bolt from the barrel and cycling the action. As the slide assembly moves rearward, it cocks the hammer and ejects the fired shell. After full rearward travel, the slide assembly returns forward, picks up a new shell from the magazine and chambers it. After the last shell has been fired, the slide assembly locks to the rear for faster reloading.

Because inertia shotguns don't need to hide any gas pistons or external linkages they tend to be thinner and less bulky than gas-operated shotguns. The reduction of total parts means that they're typically lighter than gas-operated shotguns, they're also easier to disassemble and clean. Lubrication is also less vital because of the necessarily loose fit between the bolt carrier and the receiver walls.

ASSEMBLY

AIS 12 inertia tactical shotgun is delivered in the box with the barrel removed from the receiver.



It comes with the parts below;

1. Stock-receiver-bolt- forend unit (1 piece)
2. Barrel unit (1 piece)
3. Muzzle break (1 piece – Optional)
4. Choke tubes (5 pieces – Optional)
5. Choke tube wrench (1 piece – Optional)
6. Magazine limiter plug (1 piece – Optional)
7. 7 rounds magazine tube group (1 piece – Optional)
8. 10 rounds magazine tube group (1 piece – Optional)
9. Nato 1 ¼ " quick disconnect swivel (2 pieces – Optional)

1. Always keep the firearm pointed in a safe direction.

2. Remove any packing assembly materials.

3. Unscrew the magazine cap by turning it counter-clockwise. (Fig. 1)

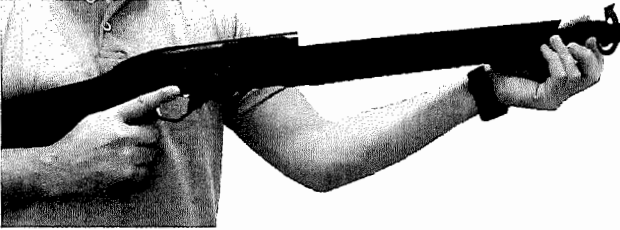

Fig. 1

4. Remove the barrel with barrel-forend gap spring together from the magazine tube. (Fig. 2)

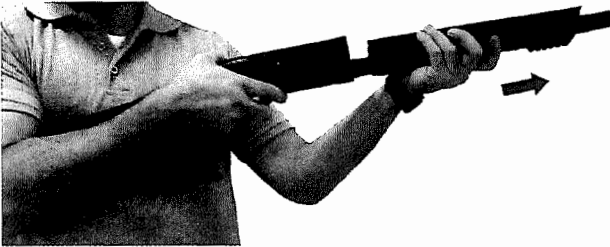

Fig. 2

5. Assemble the barrel and forend with barrel-forend gap spring. (Fig. 3)



Fig. 3

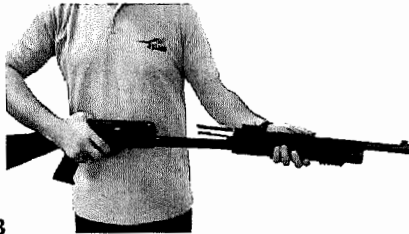

Fig. 4

6. Assemble the barrel and forend onto receiver that were assembled before. (Fig. 4)

7. Make sure the barrel and forend are seated tightly by turning the magazine cap clockwise. (Fig. 5)

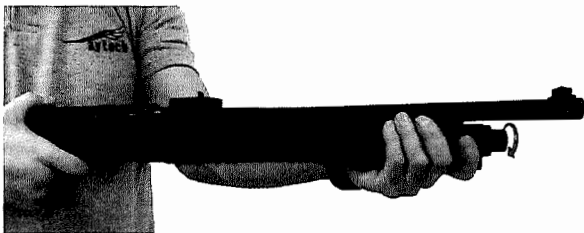

Fig. 5

MANUAL SAFETY

The manual safety button is designed to prevent the trigger from being pulled when in the on safe position and it's located at the rear of the trigger guard. (Fig. 6) In the off safe position, a red warning band is visible on the safety button on the left side of the trigger guard. To place the firearm on safe, press the manual safety button to the right. To move the safety to the off safe or fire position, press the manual safety button to the left. This exposes the red warning band on the manual safety button.

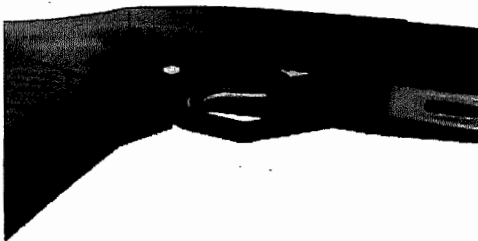

Fig. 6

LOADING

1. When loading your shotgun always keep the muzzle pointed in a safe direction, always put the manual safety button in "ON" or "SAFE" position.
2. During loading, never allow fingers or any other objects to contact the trigger.
3. Make sure that the firearm is not loaded by opening the bolt with the charging handle and closing it again by pushing the bolt release button.
4. Pull the charging handle completely rearward. (Fig. 7)

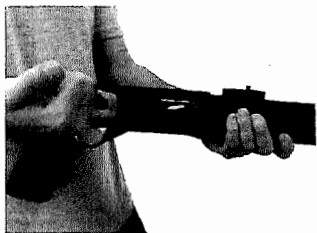

Fig. 7

5. Load the first shell through the ejection port located on the right side of the receiver. Close the bolt assembly fully by pressing the bolt release, chambering the shell. (Fig. 8)



Fig. 8

6. Push the shells of the correct gauge, one at a time, past feed latch into the magazine tube, ensuring the rim of each shell engages the feed latch and is held inside the magazine tube. (Fig. 9)

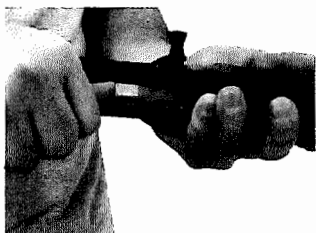

Fig. 9

7. Pull the charging handle fully rearward to release a round from the magazine then release, chambering the staged round.

8. The shotgun is now fully loaded and ready to fire. By switching the safety to the "OFF" or "FIRE" position the firearm is ready to fire.

FIRING

1. With the muzzle pointed in a safe direction and the firearm held in the proper firing position, move the safety button fully forward to the "OFF" (FIRE) position. Pulling the trigger through its full travel to the rear will fire the firearm. Ensure the muzzle is pointed in a safe direction before placing your finger on the trigger.

2. After firing, the empty cartridge will be automatically ejected through the ejection port. Be sure all observers are clear of the path of ejection, as the empty cartridges are thrown out with considerable force and could cause injury.

3. This firearm automatically feeds the next live cartridge from the magazine tube into the chamber each time the firearm is fired, until all cartridges in the magazine tube are fired.

4. This firearm is designed so that when all cartridges have been fired, the bolt will automatically lock rearward in the open position. You should never use this feature as a guide for determining if the firearm is empty! Always visually and physically inspect the chamber, elevator, and magazine tube for the presence of ammunition to ensure the firearm is completely unloaded.

5. Should any cartridge fail to fire, keep the muzzle pointed in a safe direction for at least (30) seconds in case the cartridge is a "hangfire" (delayed firing of the cartridge after being struck by the firing pin). Move the safety button fully rearward to the "ON" (SAFE) position. Then pull the charging handle fully rearward to extract and eject the misfired cartridge. Segregate the misfired cartridge from other ammunition. Do not attempt to refire a misfired cartridge.

6. After firing or when shooting is no longer imminent, put the safety button in "ON" or "SAFE" position.

UNLOADING

1. Always keep the firearm pointed in a safe direction throughout the unloading process.
2. Move the safety button to the "ON" or "SAFE" position.
3. Pull the charging handle fully rearward, extracting and ejecting the chambered shell.
4. Chamber the staged shotshell by releasing the bolt.
5. Repeat steps 3 thru 5 until all shotshells are removed from the firearm. When all shotshells are removed from the firearm, the bolt will remain open in the locked position.
6. With the bolt locked open, visually check the chamber, ejection port, and magazine to make sure the firearm is completely unloaded and the barrel is free of obstructions.

DISASSEMBLY

1. Always keep the firearm pointed in a safe direction.
2. Move the safety button to the "ON" or "SAFE" position.
3. Completely unload the chamber and magazine.
4. With the bolt locked open, visually check the chamber, ejection port, and magazine making sure the shotgun is completely unloaded.
5. Bring the bolt to rearward position by pushing the cartridge drop lever. (Fig. 10)

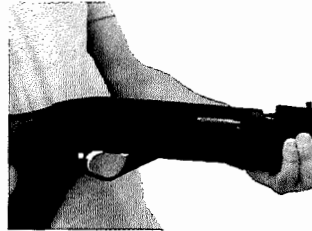
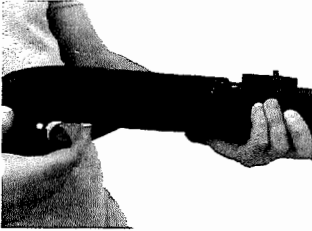

Fig. 10

6. Unscrew the magazine cap by turning it counter-clockwise. (Fig. 11)

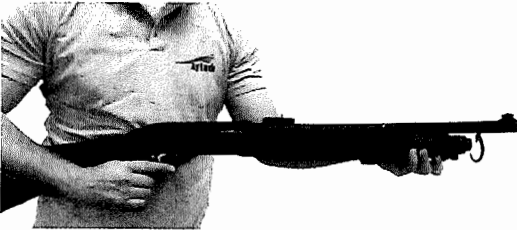

Fig. 11

7. Remove the forend and barrel from magazine tube by sliding forward. (Fig. 12)

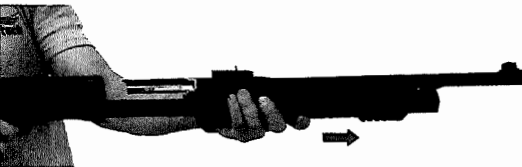

Fig. 12

To disassemble bolt group assembly;

8. Push the carrier latch by holding the charging handle and release it to forward position. (Fig. 13)



Fig. 13

9. Take out the charging handle by pulling it out. (Fig. 14)

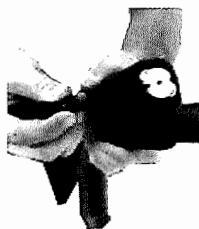

Fig. 14

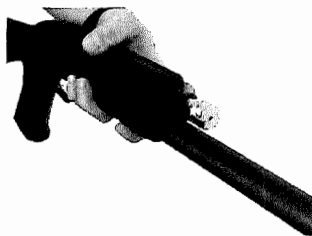

Fig. 15

10. Pull out the bolt assembly by sliding it forward. (Fig. 15)

DISASSEMBLY OF THE BOLT

1. While holding the firing pin and firing pin spring in place, remove the firing pin retaining pin from the bolt assembly. (Fig. 16)



Fig. 16



Fig. 17

2. Remove the firing pin and firing pin spring from the bolt. (Fig. 17)
3. Remove the locking head pin from the bolt. (Fig. 18)

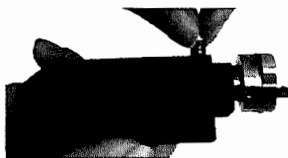

Fig. 18



Fig. 19

4. Pull the locking head from the bolt body. (Fig. 19)
5. Remove the inertia spring from its seat in the bolt, dropping it into the palm of your hand. (Fig. 20)

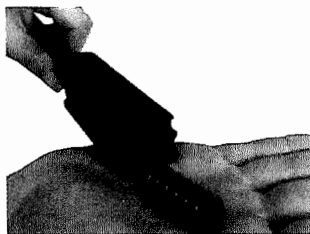

Fig. 20

DISASSEMBLY OF THE STOCK

1. Always keep the firearm pointed in a safe direction.
2. Move the safety button to the "ON" or "SAFE" position.
3. Completely unload the chamber and magazine.
4. Unscrew the recoil pad screws as shown on (Fig. 21) by turning them counter-clockwise.



Fig. 21



Fig. 22

5. Separate the stock off from the recoil pad.
6. Unscrew M8x25 hex bolt by turning it counter-clockwise. (Fig. 22)
7. After unscrewing M8x25 hex bolt, remove the stock nut and stock locking plate. (Fig. 23)

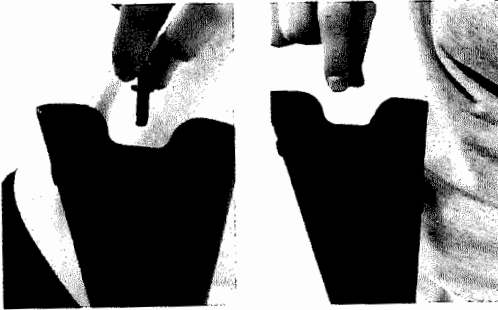

Fig. 23

8. Remove the stock through recoil tube by sliding forward. (Fig. 24)



Fig. 24

DISASSEMBLY OF THE TRIGGER

1. Always keep the firearm pointed in a safe direction.
2. Move the safety button to the "ON" or "SAFE" position.
3. Completely unload the chamber and magazine.

WARNING! To be able to remove the trigger group assembly, stock group assembly should be disassembled first.

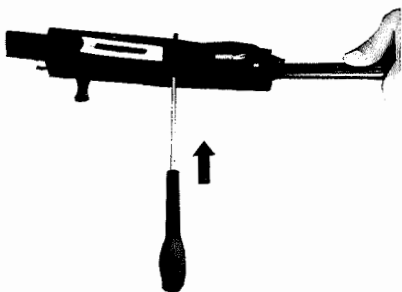

Fig. 25

4. Push the trigger guard pin out of the stock/receiver assembly using an appropriate punch from left to right. (Fig. 25)



Fig. 26

5. Pull the trigger guard assembly out of the receiver with the right hand. (Fig. 26)

ASSEMBLY OF THE STOCK

1. Assemble the stock to the receiver through the recoil tube by sliding forward.
2. Place stock locking plate.
3. Assemble M8x25 hex bolt to the stock nut by turning it clockwise.
4. Reassemble recoil pad, screw recoil pad screws by turning them clockwise.

DISASSEMBLY OF THE MAGAZINE TUBE

1. Always keep the firearm pointed in a safe direction.
2. Move the safety button to the "ON" or "SAFE" position.
3. Completely unload the chamber and magazine.
4. With the bolt locked open, visually check the chamber, ejection port, and magazine making sure the shotgun is completely unloaded.
5. Bring the bolt to rearward position by pushing the cartridge drop lever. (Fig. 27)

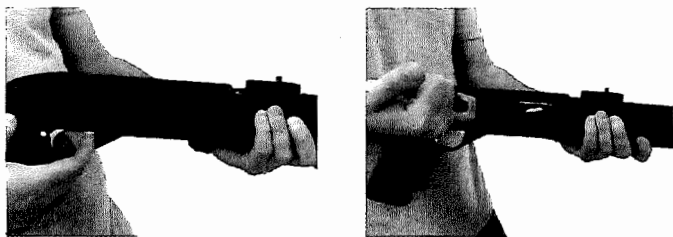

Fig. 27

6. Unscrew the magazine cap by turning it counter-clockwise. (Fig. 28)

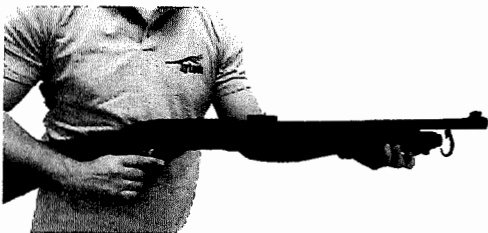

Fig. 28

7. Remove the forend and barrel from magazine tube by sliding forward. (Fig. 29)

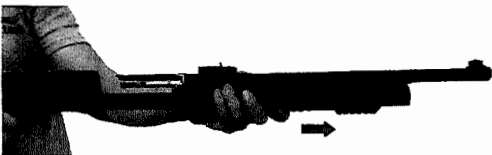

Fig. 29

8. Push the Pin-1 as shown on (Fig. 30).

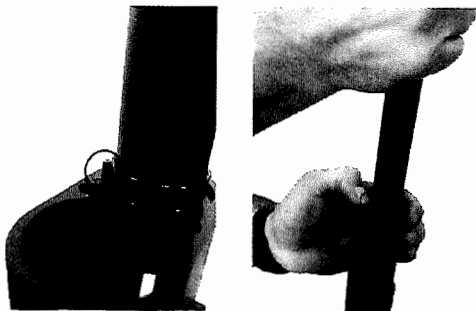

Fig. 30

9. Remove the magazine tube from the receiver by turning it counter-clockwise while pushing Pin-1. Be careful and act slowly to be able to check the spring. (Fig. 31)



Fig. 31

10. Position the new magazine tube onto its place on receiver. (Fig. 32)



Fig. 32

11. Push the Pin-1 shown on photo, assemble the magazine tube to the receiver by turning it clockwise. (Fig. 33)



Fig. 33

12. Make sure the Pin-1 grips the magazine-receiver nut as shown on (Fig. 34)



DO

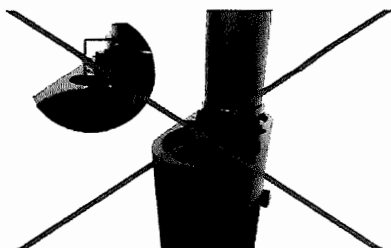

Fig. 34

DON'T

13. If you're sure that the magazine-receiver nut grips Pin-1 accurately, assemble barrel and forend. (Fig. 35)

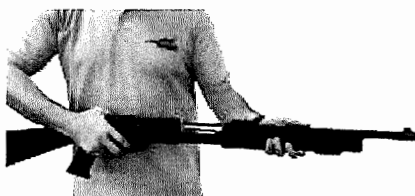

Fig. 35

14. Make sure the barrel and forend are seated tightly by turning the magazine cap clockwise. (Fig. 36)

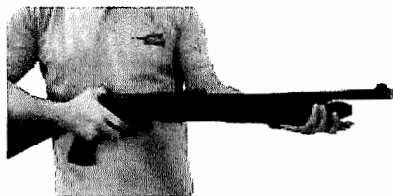

Fig. 36

MAINTENANCE

WARNING: Before attempting any work on your shotgun, make sure that the chamber and the magazine of your shotgun are unloaded.

Thanks to its extreme simplicity and careful choice of materials, AIS 12 tactical shotgun does not require any special maintenance, aside from the following simple operations:

1. Routine barrel cleaning after shooting.

- a. Remove & clean choke tube and choke tube recess in barrel.

CAUTION: Leave the choke tube installed when cleaning the bore to prevent residue from being deposited on the internal barrel threads.

2. Clean any fouling or debris from receiver and oil bolt rails and outside of the magazine tube.

3. The bolt assembly can also become fouled with powder residue and should be routinely stripped, cleaned and oiled.

4. Clean any fouling or debris from trigger assembly. Keep all parts oiled to keep the shotgun in working condition.

AMMUNITION

USE ONLY SUITABLE AMMUNITION: This semi-automatic shotgun is chambered in 12 gauge. It has been designed to fire 2¾" (70mm) to 3" (76mm) length with lead or steel shot. Use of Full or Improved Modified choke tubes is not recommended with steel shot.

Note: No adjustments to the shotgun are necessary to fire any of the ammunition listed above.

WARNING: Never use cartridges with a case longer than the chamber, as this would have serious consequences for both the gun and the shooter.

WARNING: Use ONLY factory loaded ammunition. Use of re-loaded ammunition voids the 2-Years Factory Warranty.

Note: Always use ammunition that is powerful enough to fully cycle the action. Minimum recommended load 7/8 oz shot / 3 drams of powder.

CHOKE TUBE OPERATION (Optional)

To change or clean the internal choke, proceed as follows:

WARNING: Visually and manually check to be sure no ammunition is present in the chamber or magazine.

1. Unscrew the internal choke using the special choke wrench supplied with the shotgun and extract it completely from the barrel seat.
2. If the barrel threads are fouled, clean with solvent and synthetic bristle brush.

3. Clean choke tube threads and apply appropriate lubricant prior to installation. To replace the choke tube, follow the same procedure, using a clockwise turn, until the choke tube is completely fitted into the end of the barrel.

CAUTION: When properly assembled, the choke tube should not protrude from the end of the barrel. **NOTE:** Complete the choke assembly by thoroughly tightening it in place with the supplied choke wrench.

CAUTION: Before using the shotgun, make sure that the choke wrench has been removed from the barrel muzzle. **Note:** Before the shotgun is put away, cleaning the internal choke and its barrel thread is recommended.

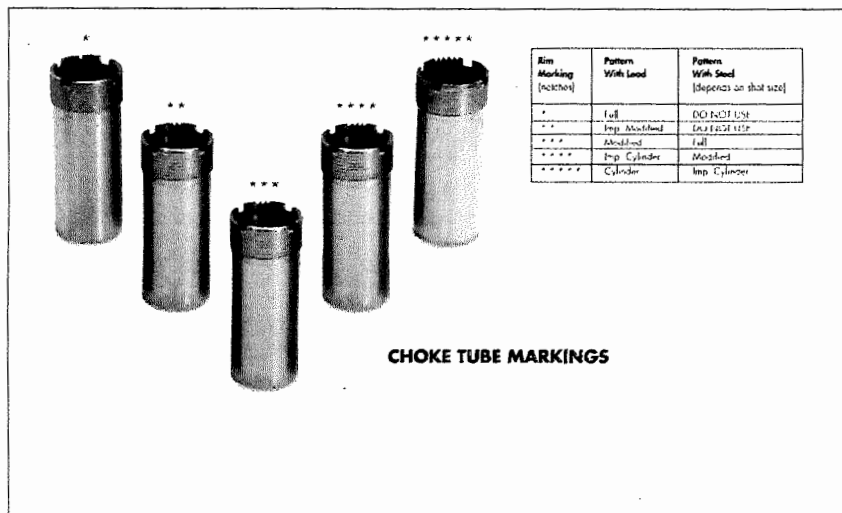

TECHNICAL DRAWINGS AND PARTS LIST

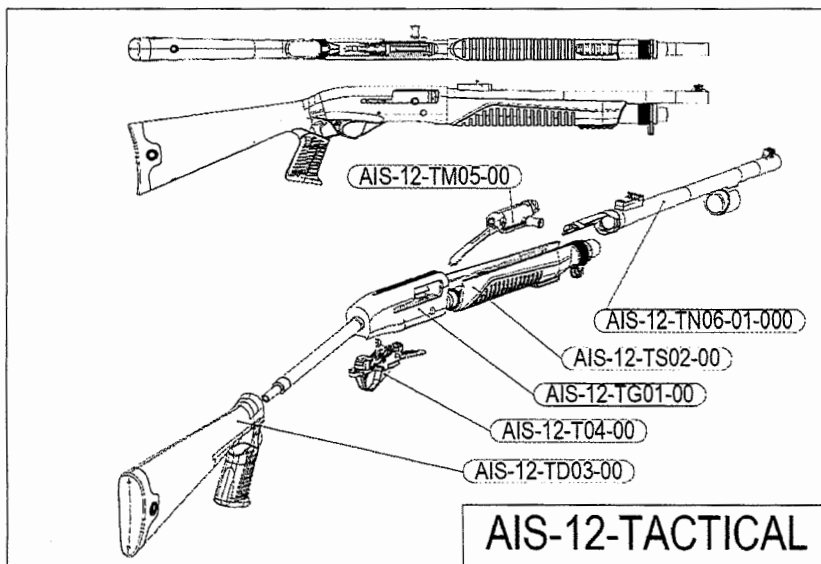

GENERAL ASSEMBLY PART LIST AIS-12-T00			
SERIAL NO	PART NO	PART NAME	QUANTITY
1	AIS-12-TG01-00	RECEIVER GROUP ASSEMBLY	1
2	AIS-12-TS02-00	MAGAZINE GROUP ASSEMBLY (3 SIZE)	1
3	AIS-12-TD03-00	STOCK GROUP ASSEMBLY	1
4	AIS-12-T04-00	TRIGGER GROUP ASSEMBLY	1
5	AIS-12-TM05-00	BOLT GROUP ASSEMBLY	1
6	AIS-12-TN06-01-000	BARREL GROUP ASSEMBLY (4 SIZE)	1

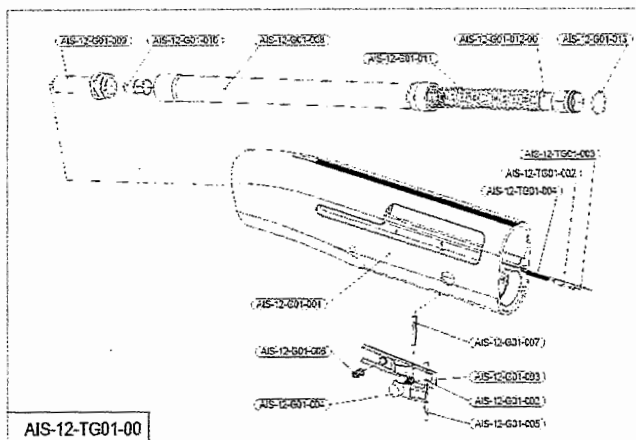

RECEIVER GROUP ASSEMBLY PART LIST AIS-12-TG01-00			
SERIAL NO	PART NO	PART NAME	QUANTITY
1	AIS-12-G01-001	RECEIVER	1
2	AIS-12-G01-002	CARRIER LATCH	1
3	AIS-12-G01-003	CARRIER LATCH EXTRACTOR SPRING	1
4	AIS-12-G01-004	CARRIER LATCH EXTRACTOR	1
5	AIS-12-G01-005	CARRIER LATCH EXTRACTOR PIN	1
6	AIS-12-G01-006	CARRIER LATCH SPRING	1
7	AIS-12-G01-007	SPRING PIN	1
8	AIS-12-G01-008	RECOIL TUBE	1
9	AIS-12-G01-009	RECEIVER-STOCK NUT	1
10	AIS-12-G01-010	SHOCK ABSORBER	1
11	AIS-12-G01-011	RECOIL SPRING	1
12	AIS-12-G01-012-00	BUFFER	1
13	AIS-12-G01-013	CIRCLIP	1
14	AIS-12-TG01-004	SPRING	1
15	AIS-12-TG01-002	PIN-1	1
16	AIS-12-TG01-003	RECEIVER PIN	1

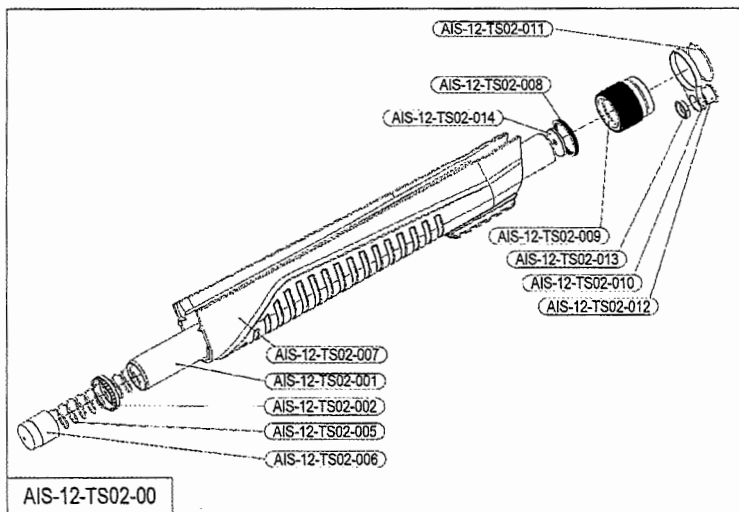

MAGAZINE GROUP ASSEMBLY PART LIST AIS-12-TS02-00			
SERIAL NO	PART NO	PART NAME	QUANTITY
1	AIS-12-TS02-001	MAGAZINE TUBE	1
2	AIS-12-TS02-002	MAGAZINE-RECEIVER NUT	1
3	AIS-12-TS02-005	MAGAZINE SPRING	1
4	AIS-12-TS02-006	MAGAZINE SPRING RETAINING CAP	1
5	AIS-12-TS02-007	FOREND	1
6	AIS-12-TS02-008	BARREL-FOREND GAP SPRING	1
7	AIS-12-TS02-009	MAGAZINE CAP	1
8	AIS-12-TS02-010	MAGAZINE CAP RING	1
9	AIS-12-TS02-011	MAGAZINE CAP RETAINING RING	1
10	AIS-12-TS02-012	SLING SWIVEL BUSHING	1
11	AIS-12-TS02-013	SLING SWIVEL BUSHING NUT	1
12	AIS-12-TS02-014	MAGAZINE WASHER	1

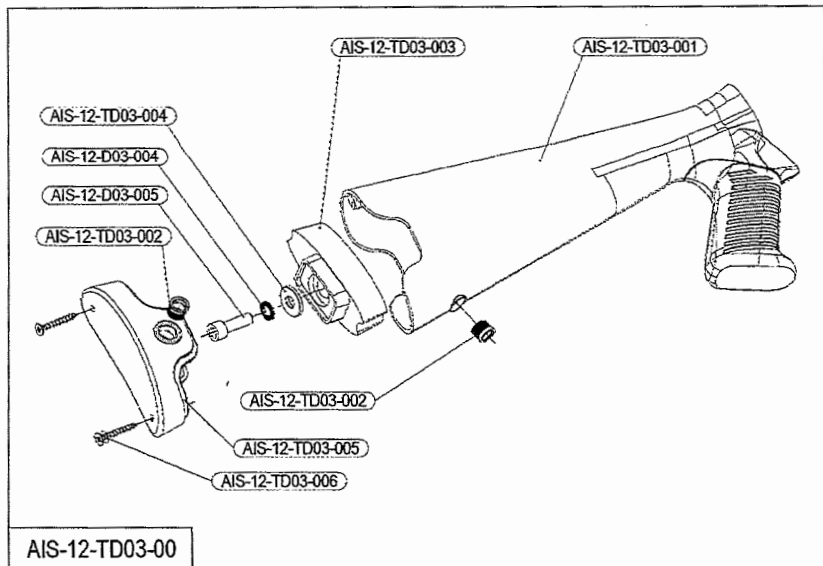

STOCK GROUP ASSEMBLY PART LIST AIS-12-TD03-00

SERIAL NO	PART NO	PART NAME	QUANTITY
1	AIS-12-TD03-001	STOCK	1
2	AIS-12-TD03-002	STOCK RING BUSHING	3
3	AIS-12-TD03-003	STOCK SPACER	1
4	AIS-12-TD03-004	STOCK LOCKING PLATE	1
5	AIS-12-D03-004	STOCK NUT	1
7	AIS-12-D03-005	M8x25 HEX BOLT	1
8	AIS-12-TD03-005	RECOIL PAD	1
10	AIS-12-TD03-006	RECOIL PAD SCREW	2

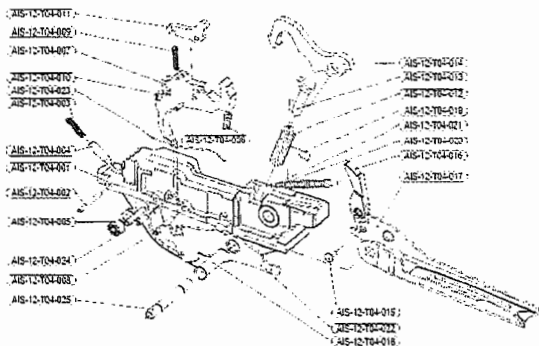

AIS-12-T04-00

TRIGGER GROUP ASSEMBLY PART LIST AIS-12-T04-00			
SERIAL NO	PART NO	PART NAME	QUANTITY
1	AIS-12-T04-001	TRIGGER GUARD	1
2	AIS-12-T04-002	SAFETY SPRING RETAINING PIN	1
3	AIS-12-T04-003	SAFETY SPRING	1
4	AIS-12-T04-004	MANUAL SAFETY PIN	1
5	AIS-12-T04-005	MANUAL SAFETY BUTTON	1
6	AIS-12-T04-006	TRIGGER SPRING	1
7	AIS-12-T04-007	TRIGGER	1
8	AIS-12-T04-008	TRIGGER PIN	2
9	AIS-12-T04-009	DISCONNECTOR SPRING	1
10	AIS-12-T04-010	DISCONNECTOR PIN	2
11	AIS-12-T04-011	DISCONNECTOR	1
12	AIS-12-T04-012	HAMMER SPRING	1
13	AIS-12-T04-013	DISCONNECTOR PLUNGER	1
14	AIS-12-T04-014	HAMMER	1
15	AIS-12-T04-015	BREECH BOLT LATCH PIN	1
16	AIS-12-T04-016	BREECH BOLT LATCH	1
17	AIS-12-T04-017	CARRIER	1
18	AIS-12-T04-018	HAMMER PIN	1
19	AIS-12-T04-019	TRIGGER GUARD PIN SPRING	1
20	AIS-12-T04-020	BREECH BOLT LATCH SPRING	1
21	AIS-12-T04-021	BREECH BOLT LATCH SPRING PIN	1
22	AIS-12-T04-022	CARTRIDGE DROP LEVER	1
23	AIS-12-T04-023	CARTRIDGE DROP LEVER SPRING	1
24	AIS-12-T04-024	CARTRIDGE DROP LEVER PIN	1
25	AIS-12-T04-025	TRIGGER GUARD PIN	1

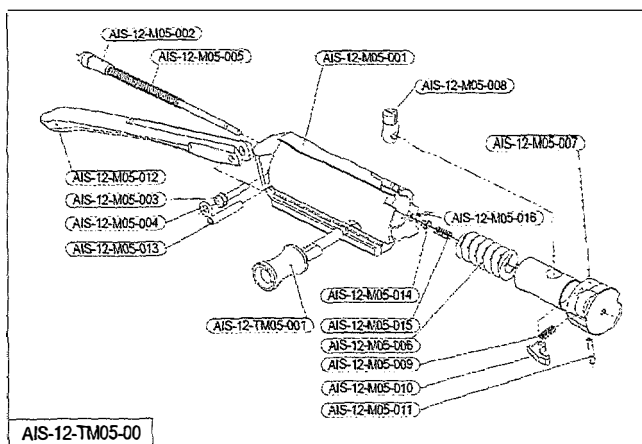

BOLT GROUP ASSEMBLY PART LIST AIS-12-TM05-00			
SERIAL NO	PART NO	PART NAME	QUANTITY
1	AIS-12-M05-001	BOLT	1
2	AIS-12-M05-002	FIRING PIN	1
3	AIS-12-M05-003	FIRING PIN RETAINING PIN	1
4	AIS-12-M05-004	O-RING	1
5	AIS-12-M05-005	FIRING PIN SPRING	1
6	AIS-12-M05-006	INERTIA SPRING	1
7	AIS-12-M05-007	LOCKING HEAD	1
8	AIS-12-M05-008	CAM PIN	1
9	AIS-12-M05-009	EXTRACTOR SPRING	1
10	AIS-12-M05-010	EXTRACTOR	1
11	AIS-12-M05-011	EXTRACTOR PIN	1
12	AIS-12-M05-012	ACTION BAR	1
13	AIS-12-M05-013	ACTION BAR PIN	1
14	AIS-12-M05-014	CHARGING HANDLE PIN	1
15	AIS-12-M05-015	CHARGING HANDLE SPRING	1
16	AIS-12-M05-016	CHARGING HANDLE SPRING PIN	1
17	AIS-12-TM05-001	CHARGING HANDLE	1

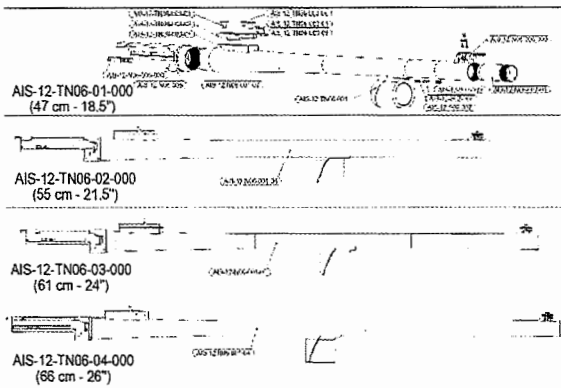

BARREL GROUP ASSEMBLY PART LIST AIS-12-TN06-00			
SERIAL NO	PART NAME	PART NO	QUANTITY
1	BARREL	AIS-12-N06-001-01	1
2	BARREL BUSHING	AIS-12-N06-005	1
3	EJECTOR	AIS-12-N06-008-000	1
4	FRONT SIGHT GROUP	AIS-12-TN06-002-00	1
5	BARREL REAR SIGHT PLATE	AIS-12-N06-009	1
6	REAR SIGHT PLATE	AIS-12-N06-010	1
7	M5x8 COUNTERSUNK BOLT	AIS-12-N06-011	2
8	REAR SIGHT	AIS-12-N06-012	1
9	SCREW PIN	AIS-12-N06-013	1
10	REAR SIGHT SCREW	AIS-12-N06-014	1
11	BARREL HOLDER	AIS-12-TN06-001	1
12	FOREND LOCK SPRING	AIS-12-S02-007	1
13	FOREND SPRING PIN	AIS-12-S02-008	1
14	FOREND LOCK SCREW	AIS-12-S02-009	1
15	CHOKE TUBE	AIS-12-N06-007-01	1

BARREL LENGTH SIZE LIST		
SERIAL NO	PART NO	PART NAME
1	AIS-12-N06-01-000	BARREL 47 cm - 18.5"
2	AIS-12-N06-02-000	BARREL 55 cm - 21.5"
3	AIS-12-N06-03-000	BARREL 61 cm - 24"
4	AIS-12-N06-04-000	BARREL 66 cm - 26"

Aytech AIS 12 Tactical Semi-Auto Inertia Shotgun Features

Gauge: 12 Ga

Barrel Length: 47 cm (18,5") – 66 cm (26")

Overall Length: 126 cm - 49.5"

Average Weight: 3100 gr - 6.8 lbs

Magazine Capacity: 5-7-10 rds

Choke: F,IM,M,IC,C (Optional) – Muzzle Break (Optional)

Stock: Polymer

Receiver Material: Aluminium

Barrel Material: 4140 Steel

Operating System: Inertia

WARRANTY

TWO (2) YEARS LIMITED WARRANTY

Aytech warrants to you, the original retail purchaser of a new Aytech® AIS 12 Inertia Shotgun ("Aytech firearm"), that the Aytech firearm will be free of defects in material or manufacture for a period of two (2) years from the date of your purchase of the new Aytech firearm (the "Warranty Period"). This is the only express warranty on the Aytech firearm. Aytech makes no other warranties of any kind or conditions, including, but not limited to any implied warranty of merchantability or fitness for a particular purpose.

Exclusions: This warranty does not cover the cosmetic appearance of the firearm or any damage caused by;

- (1) Normal wear and tear,
- (2) Failure to perform proper care and maintenance,
- (3) Accidents, abuse or neglect,
- (4) Barrel or bore obstructions,
- (5) Failure to follow the instructions and warnings that accompany the firearm
- (6) The use of defective, non-saami or non-cip standard, remanufactured, handloaded, and/or reloaded ammunition.

In addition, any unauthorized repairs, alterations or modifications to the firearm will automatically void the limited warranty.

**THANK YOU FOR CHOOSING AYTECH AIS 12 INERTIA
TACTICAL SHOTGUN.**

Serial No.

Date Purchased:

Purchased From:

Aytac Ar-Ge San. & Tic. Ltd. Şti. & Aytech Silah San. & Tic. Ltd. Sti.

Address: Yenidogan Mah. Sultangazi Cad. 172/A Sancaktepe -
Istanbul / Turkey

Tel: +90216 4845300

Web: www.aytecharms.com

Specifications within this owner's manual are correct at the time of printing
and subject to change without notice.

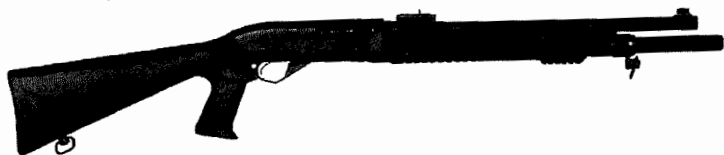

U.S.A. DISTRIBUTOR: IMG
ADDRESS: 126 Corporate Dr
Frankfort, KY 40601, United States
PH: (859) 285-7110
E-MAIL: sales@imgww.com
Web: www.imgww.com

